

AA Section Detail
SCALE: 1:100

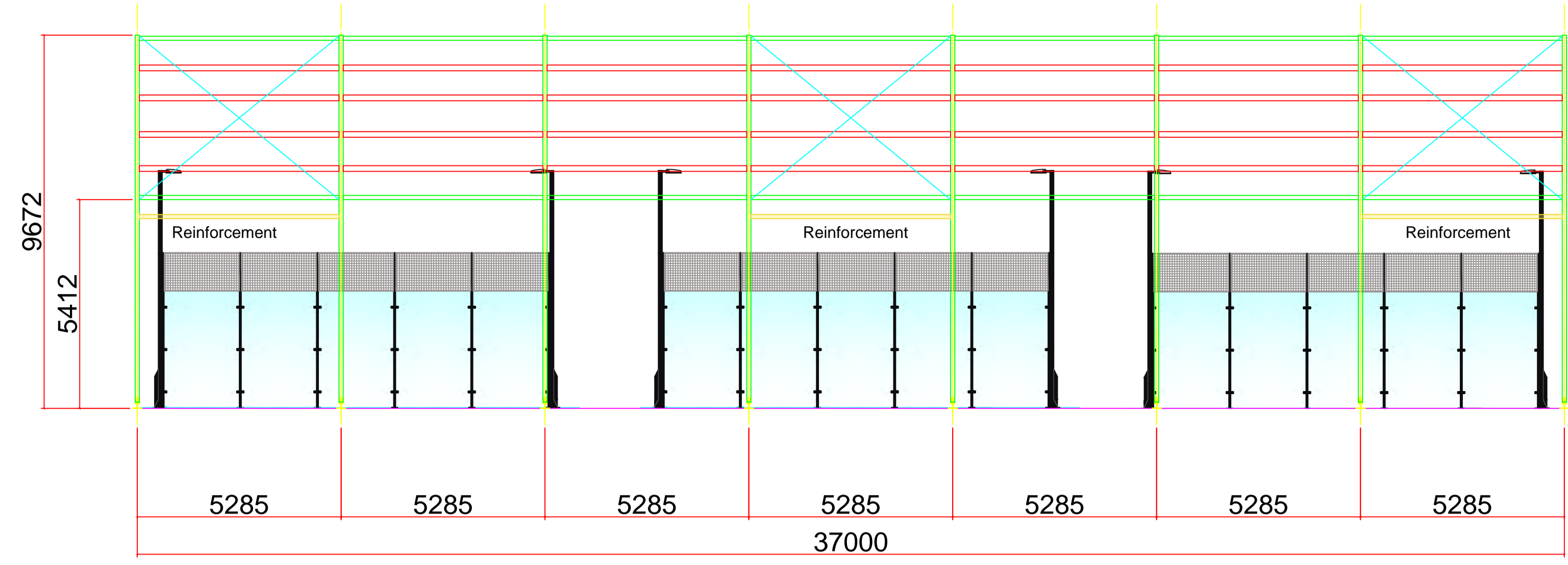

WEST VIEW

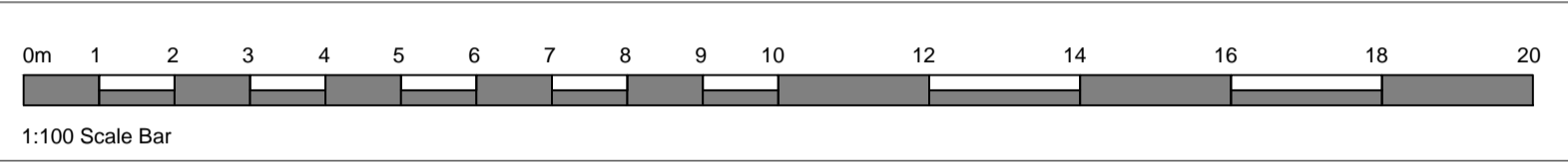
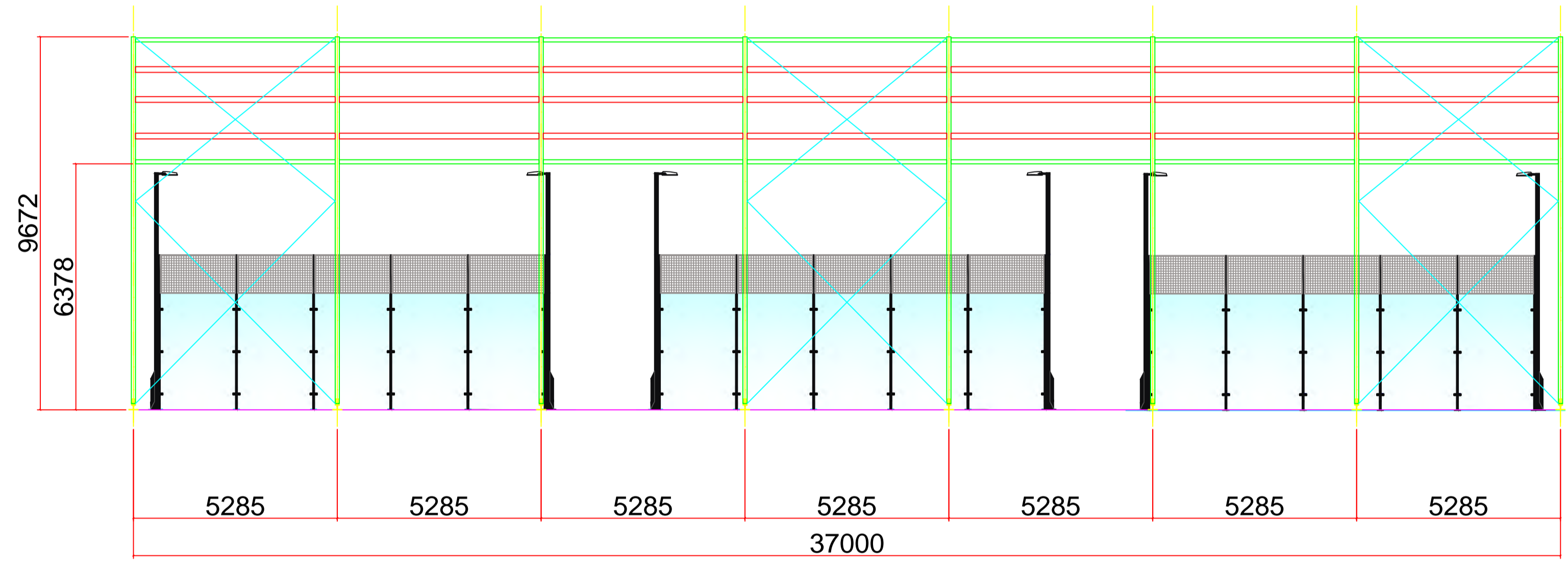

EAST VIEW

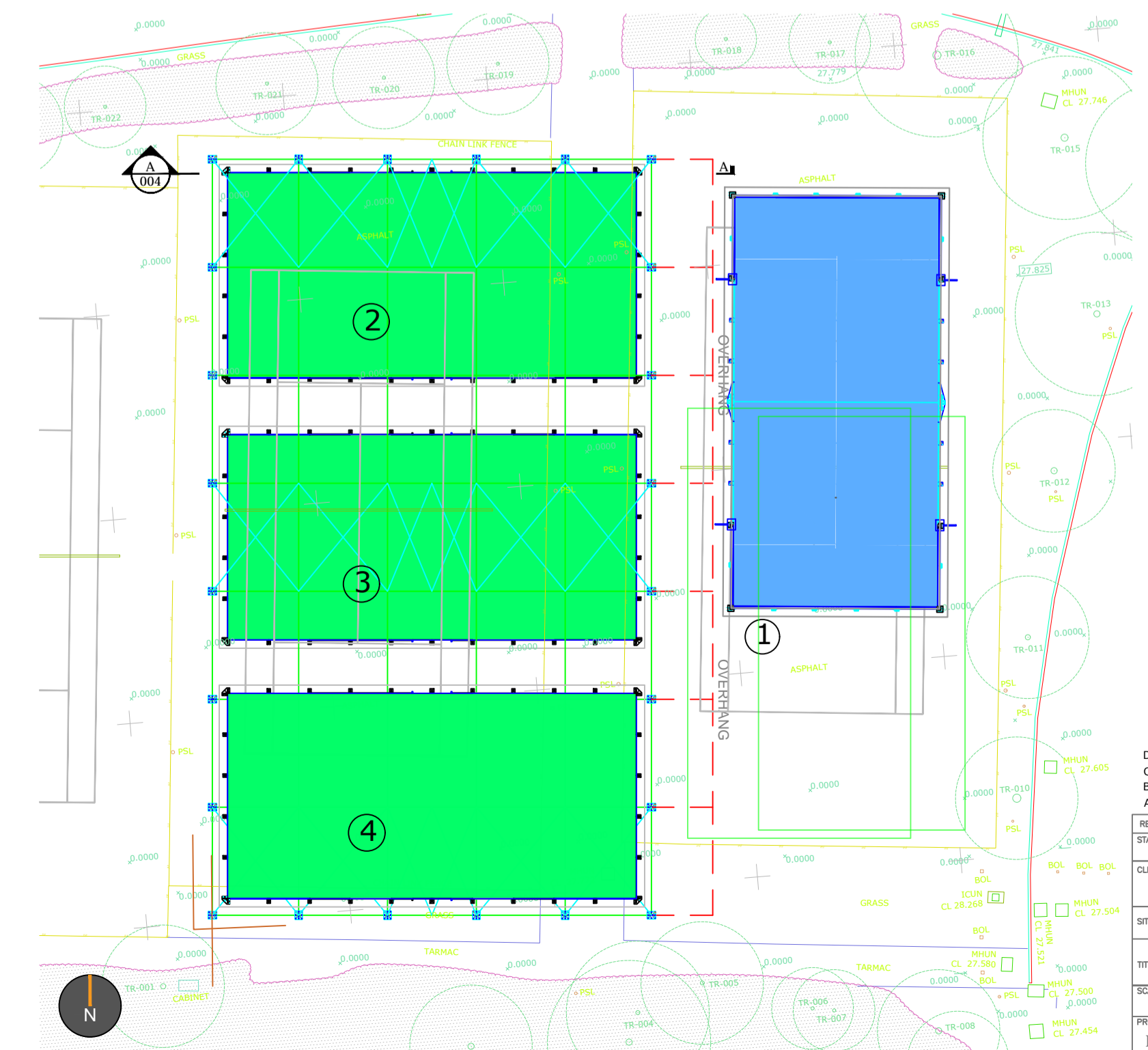
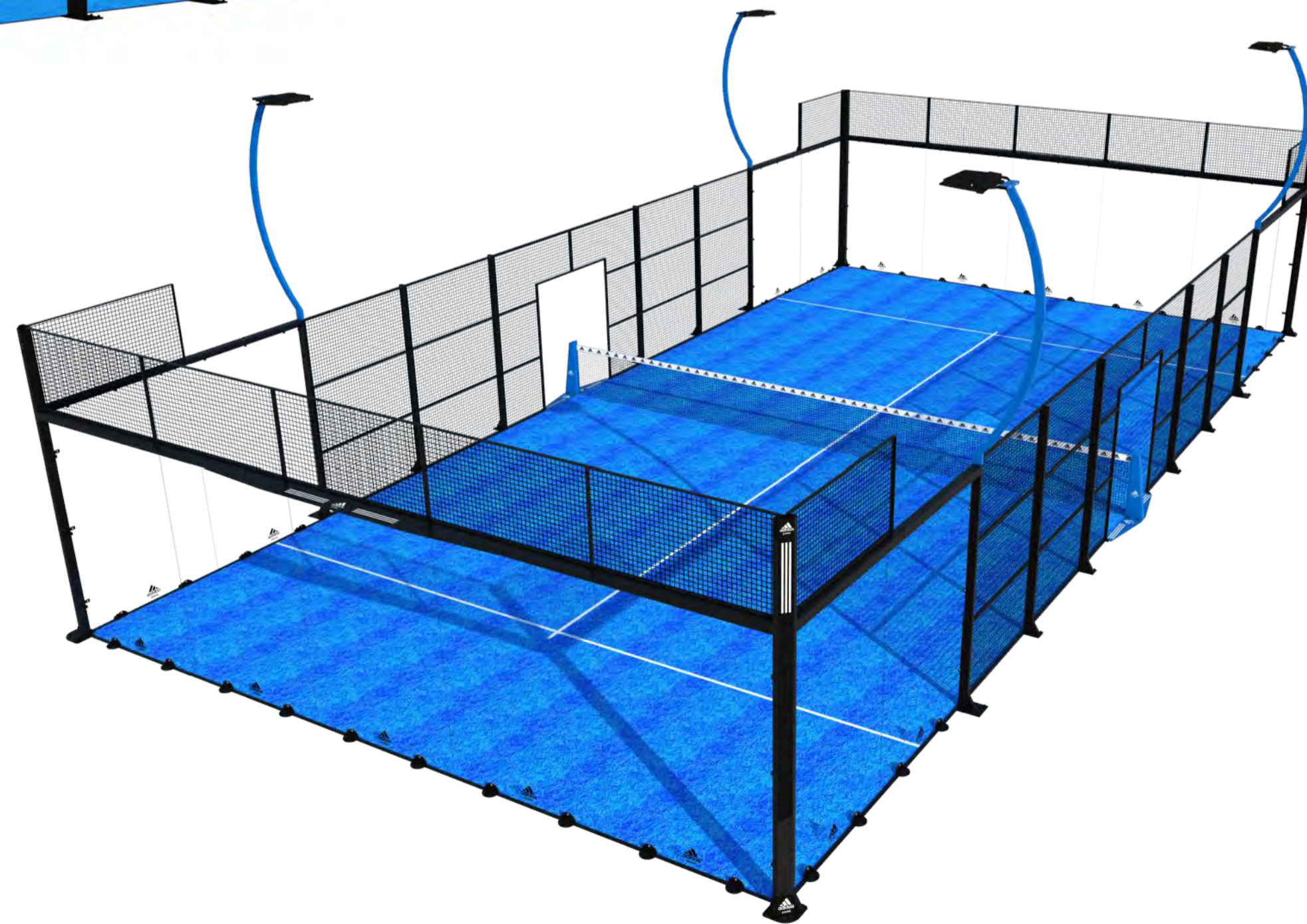
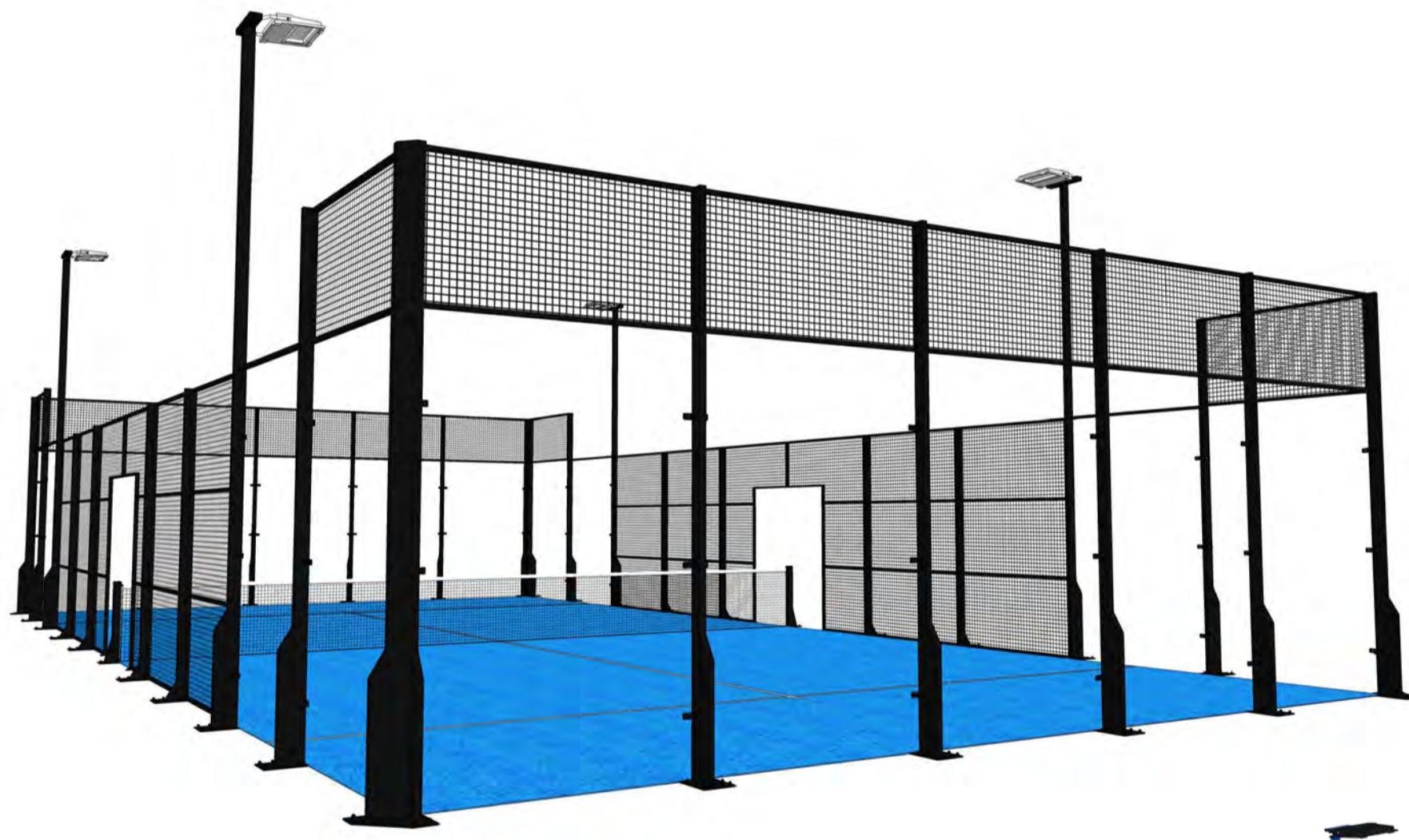

D	Alternative canopy	AP	14/08
C	Alternative canopy	AP	20/05
B	Planning Submission	AP	20/05
A	First Issue	AP	14/02
REV	DESCRIPTION	BY	DATE
	Planning		
CLIENT:	Southend Leisure & Tennis Centre		
SITE:	Garron Park Cricket Ground		
TITLE:	Section Details		
SCALE:	1:100 (A1)	DATE:	10/02/2020
PROJECT NO:	FT1902-10	DRAWING NO:	1902-10-004
CHECKED:	AGP	REVISION:	PR
			D

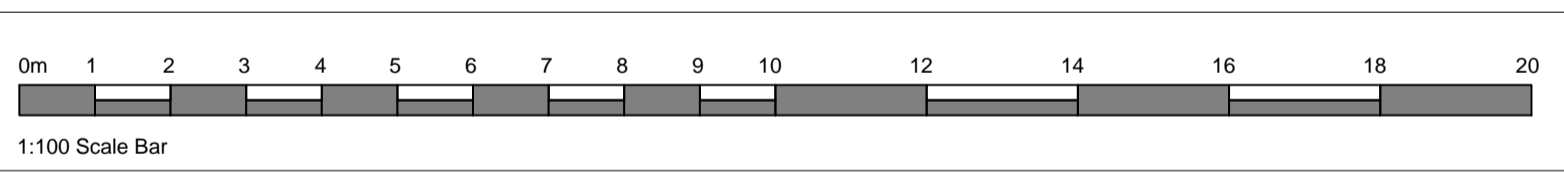
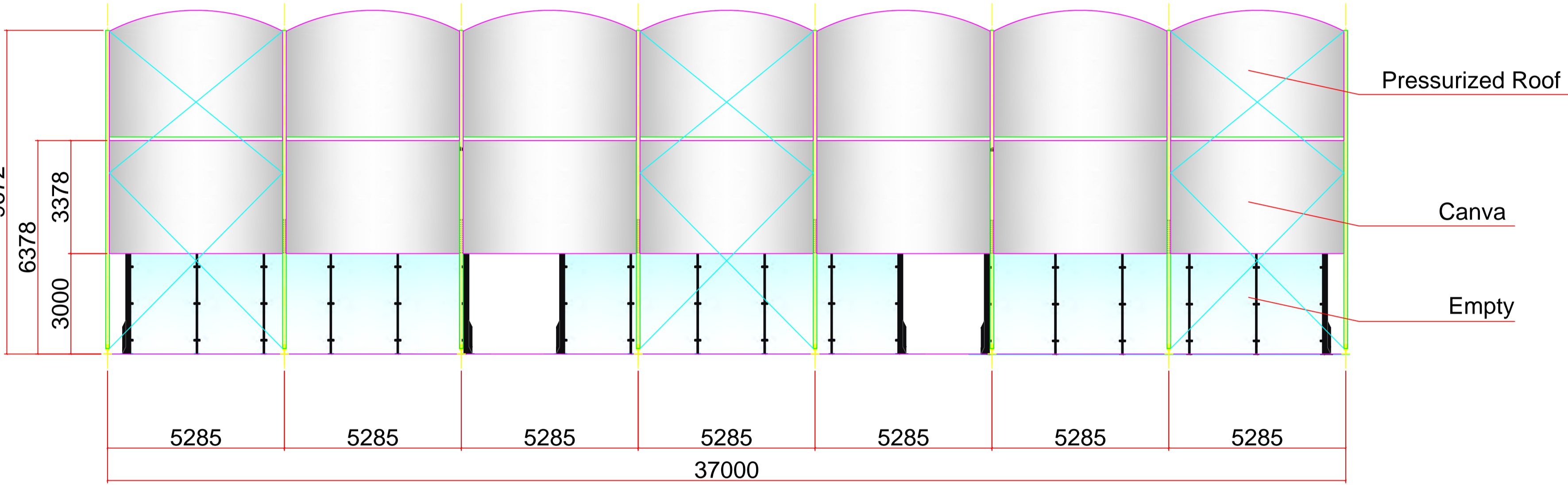
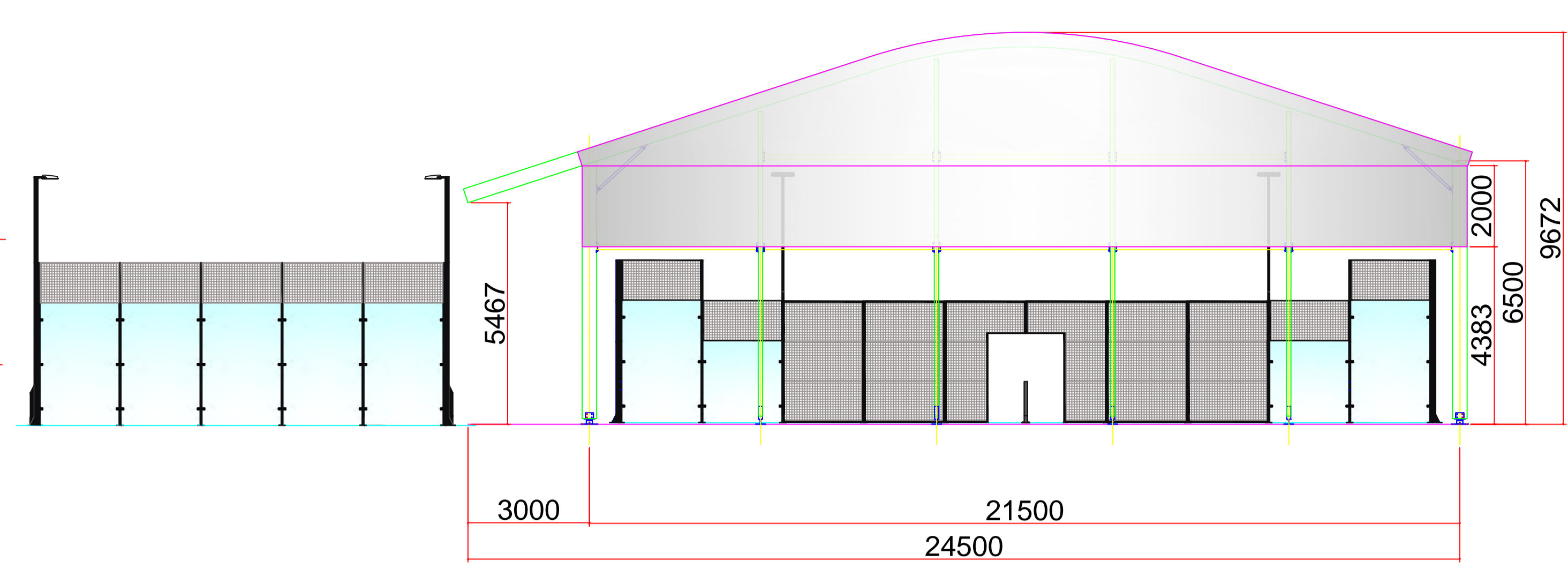
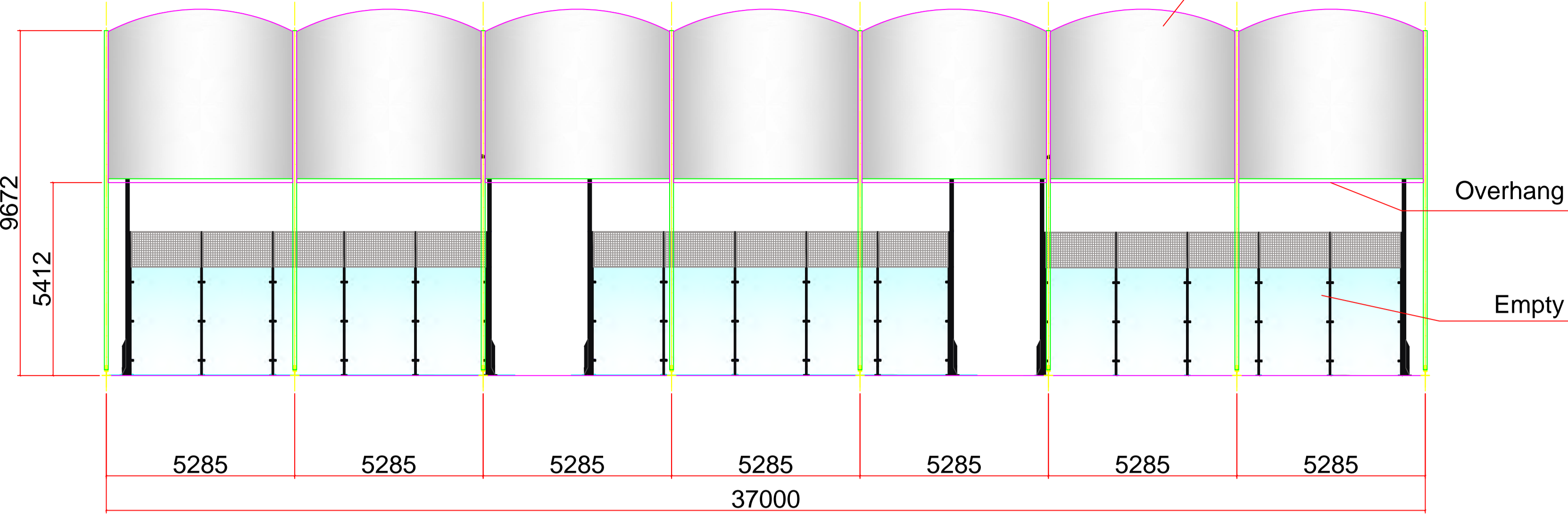

Canopy Specification:

Calculated according to standard: UNE 13782 Dimensions:

- Width 21,5m (24,5m with overhang)
- Length37m
- Eaves height6m
- Overall height 9.6m (max height)

Total area906m²

1. The supporting structure consists of arches of profiles high strength aluminium extrusion (alloy 6082 T6).
2. The joining parts are made of ST-235 hot-dip galvanized steel. The posts are joined together by straps and braces of aluminium and / or cold formed steel with galvanized treatment.
3. The bracing of the structure is done by galvanized cables protected with p.v.c.

coating and the fasteners are galvanized hardware. The anchorage of the plates to the ground is by means of expansion plugs, rod with epoxy resin.

4. Pressurized textile membrane cover, vertical panels to 4 m from fgl.
 - Consists of two layers of polyester textile membrane coated with P.V.C, with Keder welded in high frequency on both sides to ensure the air tightness of the structure. The two layers of canvas form an air chamber with a pressure of 0.8 mbar providing greater thermal insulation and better resistance against wind and snow. The cover is inflated and the pressure is maintained by means of a pressure switch using a 105W low-power pump.
 - Technical specifications: - Base fabric: polyester - Weight / m²: 640gr -
 - Fire behavior: B-s3, d0 (M2) -
 - Color: Translucent White - Surface finish:
 - Exterior Matt non reflective finish with branding on the elevations.

Application standards:

- Aluminum extrusion according to UNE 7753 standard
- Hot dip galvanizing according to UNE ENISO1461 standard
- Zinc plating hardware according to ISO S-944/18 certificate
- Cable crimping according to UNE EN13414-1 standard

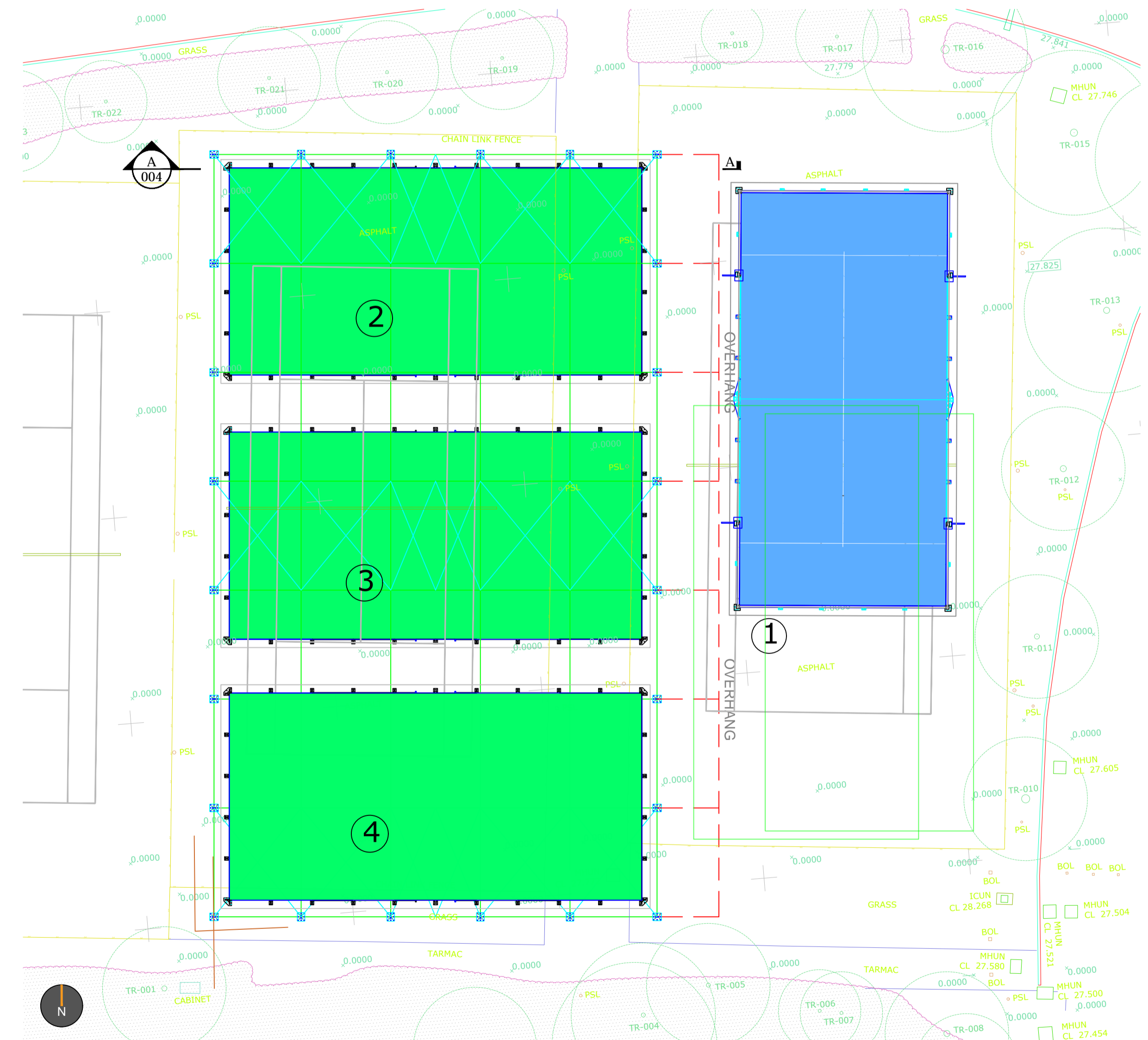

C	Alternative canopy	AP	14/08
B	Alternative canopy	AP	30/05
A	First Issue	AP	14/02
REV	DESCRIPTION	BY	DATE
Planning			
CLIENT: Southend Leisure & Tennis Centre			
SITE: Garron Park Cricket Ground			
TITLE: External Elevations			
SCALE: AP	DATE: 10/02/2020	DRAWN: ACP	CHECKED: PR
PROJECT NO: FT1902-10	DRAWING NO: 1902-10-005	REVISION: C	